

## 2012 PREFERRED RATE SCHEDULE

Applies to advance reservations and AAA members

Maximum #  
of Occupants

May 1 - 23  
Sept. 10 - 12  
Sept. 17 - 19

May 29 - June 3  
Sept. 4 - 5

June 4 - 17

June 18 - 30

July 1 - Aug. 25  
Aug. 30 - Sept. 3

Aug. 26 - 29  
Sept. 6 - 9

Sept. 20 - 22

### BUILDING 1 - LOCATED IMMEDIATELY AT BOARDWALK AND BEACH

A - Motel Unit	one double bed	2	\$ 80	\$110	\$120	\$130	\$135	\$130	\$100
B - Motel Unit	one king bed	2	\$ 90	\$120	\$130	\$140	\$145	\$140	\$115
C - Motel Unit	two double beds, front view	4-5	\$120	\$150	\$160	\$200	\$215	\$170	\$150
D - Motel Unit	two double beds, patio view	4	\$110	\$135	\$145	\$185	\$200	\$150	\$135
E - 1 Room Efficiency	two double beds, full kitchen*	4-5	\$150	\$170	\$180	\$230	\$250	\$200	\$175
E1 - 1 Room Efficiency	two double beds, full kitchen	4-5	\$135	\$160	\$170	\$220	\$240	\$185	\$165
E2 - 2 Room Efficiency	three double beds, full kitchen*	6	\$165	\$185	\$195	\$250	\$290	\$220	\$190
E3 - 2 Room Efficiency	one king bed, sofa bed, full kitchen	4	\$135	\$160	\$170	\$220	\$230	\$185	\$165

### BUILDING 2 - LOCATED ACROSS FROM BUILDING 1, BOARDWALK AND BEACH

F - 1 Room Efficiency	one king bed, full kitchen	2	\$120	\$155	\$160	\$185	\$190	\$170	\$150
G - 2 Room Efficiency	two double beds, sofa bed, full kitchen*	6	\$165	\$185	\$195	\$250	\$290	\$220	\$190
H - Motel Unit	two double beds	4	\$110	\$135	\$145	\$185	\$185	\$150	\$135
I - Motel Unit	one double bed, one twin bed	3	\$100	\$125	\$140	\$170	\$170	\$140	\$125
J - Motel Unit	two double beds	4-5	\$120	\$150	\$160	\$200	\$215	\$170	\$150
K - 2 Bedroom Efficiency Apartment (located next to Building 2)	two double beds, one king bed, sofa bed, full kitchen*	8	\$185	\$210	\$225	\$275	\$340	\$245	\$220

\* full kitchen with full size refrigerator

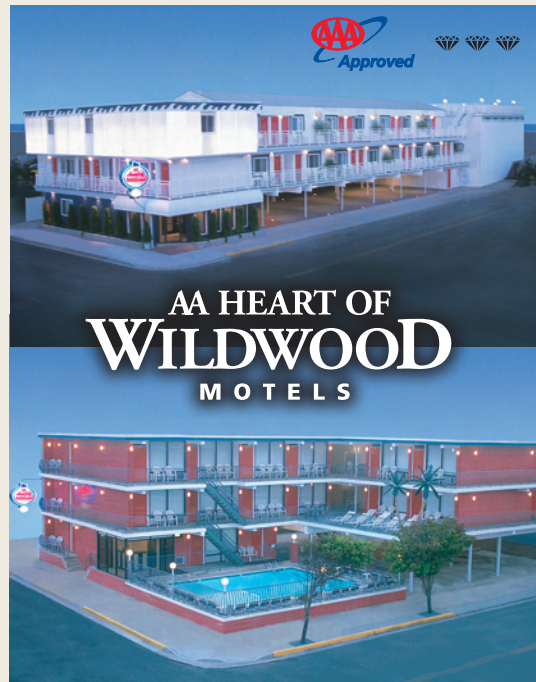

AAA HEART OF  
**WILDWOOD**  
MOTELS

#### BUILDING 1 \* indicates microwave and refrigerator

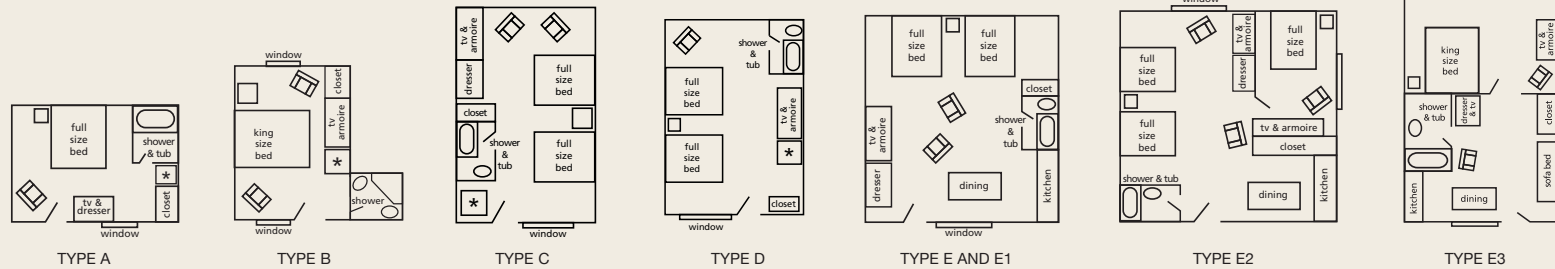

#### BUILDING 2

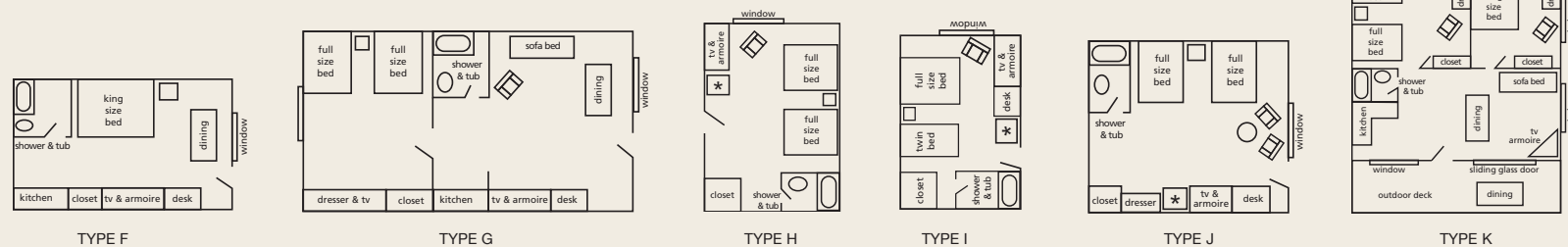

## MEMORIAL WEEKEND PACKAGES

May 24 - 28 (any 3 nights)

Enjoy the 26th Annual International Kite Festival, Vietnam Veterans Celebration of Heroes Festival, Memorial Day Ceremony and more.

Unit A . . . . .	\$345	Unit F . . . . .	420
Unit B . . . . .	360	Unit E or E1 . . . . .	510
Unit I . . . . .	385	Unit E3 . . . . .	510
Unit H or D . . . . .	435	Unit E2 or G . . . . .	555
Unit J or C . . . . .	480	Unit K . . . . .	615

10% Discount Available on 7 night minimum stay\* -  
Not available during weekends, holidays and conventions.

5% Discount Available on 5 night minimum stay\*  
(Sunday - Thursday Only)

\* Applies to advance reservations only. Certain restrictions apply.  
Cannot be combined with other discount packages.

**CHECK-IN 2PM • CHECK-OUT 10AM**

All rates are based on double occupancy. Children (2) under 17 are  
free when sharing an appropriately sized room with parents.  
Extra person: \$15 per day.

A deposit of two days rental is required to confirm reservation.  
A deposit of three days rental is required for a stay of 7 nights or more.  
E2, G and K units require a 50% deposit on stays of 4 nights or more.  
Balance due on arrival in cash, travellers cheques or credit card. All major  
credit cards accepted. Deposits refundable if notified three weeks in  
advance of arrival date; 6 weeks prior to arrival date for E2,  
G and K units. Deposits are not transferable. 10% service charge  
on all refunds.

Sorry, no pets. Off-street parking for one car per unit.

This is a non-smoking facility.  
Smoking is only permitted outside guest rooms.

RESERVATIONS 1-888-522-2248  
[www.HeartofWildwood.com](http://www.HeartofWildwood.com)